

APPLICATION SOLUTIONS: **MOTORS**

Improve Motor Reliability By Increasing The Life Of Your Bearings.

Bearings, one of the most important components of electric motors, are designed to operate for many years. Yet, over 51% of motor failures are caused by bearing failure. If you want to increase reliability and MTBR throughout your plant, protect motor bearings from the most common causes of premature bearing failure – lubrication loss and contamination ingress.

Effectively seal your bearing housing with Inpro/Seal's patented Bearing Isolator technology. The Inpro/Seal® VB45-S™ and mini66™ Bearing Isolators are IP66 rated for premium contamination protection while also ensuring lubrication retention by capturing lubricant and directing it back to the bearing housing. Their compact designs provide permanent bearing protection for your equipment without the need for modifications.



VB45-S – 0.625" Overall Length

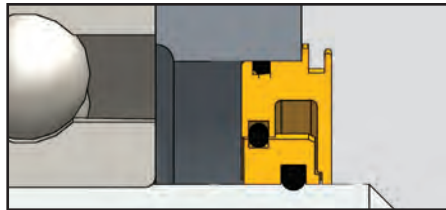

mini66 – 0.375" Overall Length

Inpro/Seal's unique non-contacting design provides energy savings by maximizing your motor efficiency with no added drag on the shaft.

Unscheduled downtime can be costly, but don't worry, Inpro/Seal has you covered. We've streamlined our operation process to offer same day shipments, even on new designs, to get your equipment running right away.

Count on us to improve motor reliability, increase MTBR, and maximize motor efficiency. We are the trusted source of bearing isolator technology with over 30 years of knowledge and real world experience to design the right custom engineered solution for you.



FACTS AT A GLANCE

Inpro/Seal® Bearing Isolators installed on motors:

- extend the life of the motor by increasing bearing reliability
- permanently protect against contamination ingress and lubrication loss
- are non-contacting and do not negatively impact motor efficiency
- can be used in both horizontal and vertical applications
- are maintenance free and will last the lifetime of your motor
- are standard on most motors designed to meet IEEE-841 specifications
- can be shipped the same day your order is placed



MOTOR REQUEST FOR QUOTE

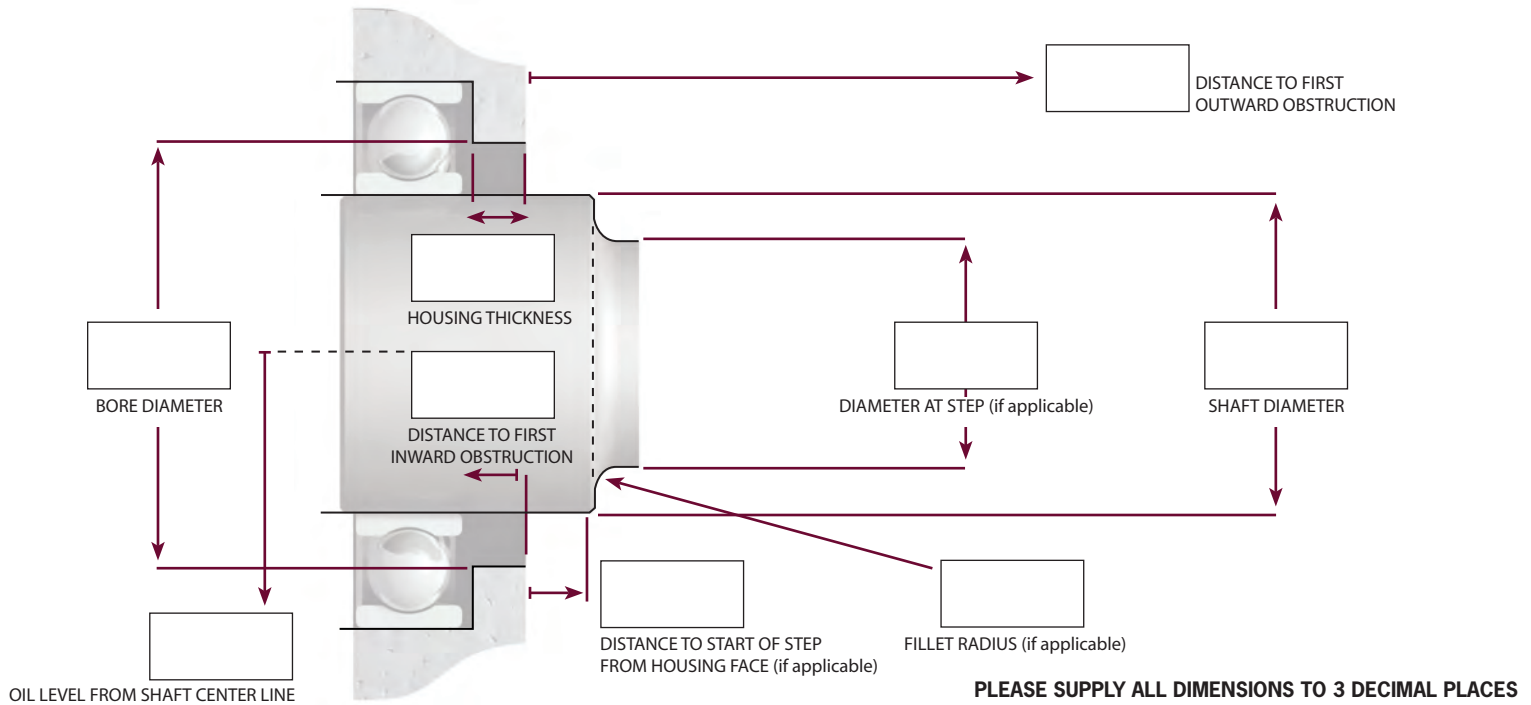

Data Needed For Quote

APPLICATION: Pump Motor Other _____

CURRENT SEALING SOLUTION: Lip Laby Other _____

SHAFT POSITION: Horizontal Vertical Up Vertical Down

BEARING TYPE: Ball Sleeve Roller

MOUNTING: Standard Press-Fit Flange Other _____

PRIMARY FOCUS: Contamination Lube Retention Both

LUBE: Oil (level) _____ Grease Oil Mist Forced Oil System

FIRST OBSTRUCTION: Step Keyway Other _____

AXIAL MOVEMENT: _____

SHAFT SPEED: _____

MISALIGNMENT:

Diametric Run Out Greater Than .005" TIR? Yes No
If yes, how much? _____

Shaft To Bore Misalignment Greater Than .007" TIR? Yes No
If yes, how much? _____

TEMPERATURE AT SEAL: °C | °F Min _____ Max _____

ENVIRONMENT: _____

HOUSING TYPE: Solid Split

SEAL TYPE: Solid Split

CONSTRUCTION MATERIAL: Bronze Stainless Other _____

TOTAL PIECES OF EQUIPMENT: _____

CONTACT FOR QUESTIONS: _____

BRIEFLY DESCRIBE THE APPLICATION

Fax RFQ sheet to 309-787-6114 or email info@inpro-seal.com